

MERIDIAN LIBRARY DISTRICT



VOTE



YES!

BOND ISSUE

WHY IS IT NEEDED?

Dramatic growth has increased library clientele.

Current library building is too small to support the increased usage.

To provide a more controlled recreational and learning environment.

WHY NOW?

The District currently has no outstanding bonded indebtedness.

Historically, construction costs and real estate costs increase over time, which means that any comparable project in the future may be more expensive.

Interest rates remain at advantageous levels.

WHAT WILL IT COST?

The proposed bond amount of \$2,600,000 would mature over a period of approximately 20 years, thus providing a low annual debt payment.

For residential property valued at \$75,000, the cost would be less than \$13.⁰⁰ a year.

DATE: FEBRUARY 7, 1995

TIME: 8:00 a.m. to 8:00 p.m.

PLACE: MERIDIAN FREE LIBRARY
18 EAST IDAHO AVENUE
MERIDIAN, IDAHO

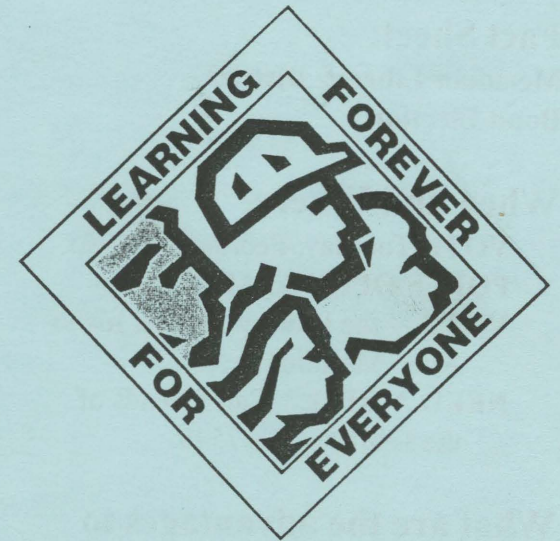

**Meridian Library
District**

**Bond Election
Fact Sheet**

**VOTE
February 7, 1995**

Fact Sheet:

Meridian Library District Bond Election

When and Where:

VOTE Tuesday, February 7, 1995

POLLS OPEN 8 AM - 8 PM

VOTE at the Library 18 East Idaho
Ave., Meridian

NEED A RIDE? Call Friends of
the Library 888-7549.

What are the advantages to the Community?

- ◆ Residents of the community will enjoy a sense of community pride in the attractive classic-style building. The public library belongs to everyone in the community.
- ◆ Residents of the community will enjoy expanded library services such as:
 1. Computers for public use
 2. Study rooms for group work and tutors
 3. Meeting room for community meetings and recitals
 4. Reading areas with comfortable seating
 5. Additional story hours

6. Additional study tables
7. Additional materials for checkout

Why is it needed?

1. Dramatic growth in population has increased library clientele.
2. The current building is too small to adequately service everybody.
 - a. Children must sign up for programs because seating is limited.
 - b. The number of programs is limited because lack of a meeting room requires that part of the library be shut off for programs.
 - c. There is no space to hold meetings or classes.
 - d. There is no space for workers to repair materials and prepare them for the public.
3. There is inadequate parking available at the current location.
4. There is inadequate space to offer such services as computers for public use, Internet access, and study areas.
5. There is inadequate shelf space for additional materials.

What will it cost the taxpayer?

- ◆ The bond amount of \$2,600,000 would mature over a period of approximately 20 years, thus the annual debt payment would be low.
- ◆ For residential property valued at \$75,000, the cost would be less than \$13.00 per year.



The Meridian District Library's \$2.6 million bond election to purchase property for a new 26,000 square foot building failed. (Valley News)

THE PROBLEM

Our community has outgrown the present library building. Many problems exist due to the crowded conditions. Problems include:

- ◆ Inadequate parking.
- ◆ No room for additional books or materials.
- ◆ No quiet spaces for study or reading.
- ◆ No room for adult or children's programs.
- ◆ Inconvenient access for the physically challenged.
- ◆ Extremely limited seating.
- ◆ No public meeting rooms for community functions.
- ◆ No public amenities such as word processing equipment.

VOTE NOVEMBER 7

THE SOLUTION

For approximately the cost of one book per year, you and your family can enjoy an upgraded library facility and services far into the 21st century. Your "yes" vote for the Meridian Library District bond will:

- ◆ Build a new library building and provide 68 parking spaces. Some of the amenities of the new building will be:
 - ◆ Community meeting room.
 - ◆ Quiet adult reading area.
 - ◆ Mom and toddler room with a view of the story room.
 - ◆ Public use Computers for word processing.
 - ◆ Study rooms for tutors and group projects.
 - ◆ Quiet study areas.
 - ◆ Expanded reference section.
 - ◆ Expanded magazine collection.
 - ◆ Expanded young adult section.
 - ◆ More programs for all ages.
 - ◆ Compact discs for checkout.

VOTE AT THE LIBRARY

THE COST

The library's growth requires community support.

The facilities project will be funded by a bond issue of \$3.4 million for land purchase, building construction, and furnishings. The bond would be paid over 20 years.

WHAT THE BOND WOULD COST YOU:

	Residences		
	A	B	Farmland
Improvements	\$85,000	\$125,000	
Land	<u>15,000</u>	<u>25,000</u>	<u>150,000</u>
	100,000	150,000	150,000
Homeowner exemption	<u>(42,500)</u>	<u>(50,000)</u>	
Market value for assessment	<u>\$57,500</u>	<u>\$100,000</u>	<u>\$150,000</u>
Estimated annual tax for sample properties	<u>\$14.38</u>	<u>\$25.00</u>	<u>\$37.50</u>

For each \$1,000 assessed valuation, the cost would be 25 cents.

*Cost estimates provided by West One Bank.

VOTE YES!!!

THE LOCATION

The Board of Trustees has selected two acres located at 1323 W. Cherry Lane for the new library building. The site was selected after completion of a needs assessments for the library building for the next twenty years and an extensive search for the perfect property.

WHY THIS LOCATION?

The property is located near the center of the community and is easily accessible. It is the right size and the cost is within the constraints of the budget.

WHY NOT EXPAND AT THE PRESENT SITE?

There is no more room to expand. The present library building fills the entire property. The lawn next door is not library property. In order to gain the needed space to accommodate Meridian's growing population, the district would have to add six stories! There is not adequate parking at the present site.

WHAT WILL HAPPEN TO THE OLD BUILDING?

The old building will be sold and the proceeds used to purchase more books and materials.

WHY NOT RENOVATE THE OLD HIGH SCHOOL BUILDING?

The old high school building was the first choice when the trustees began looking for a suitable location. Based on a report written by an outside architect and engineer, the trustees determined that the old school building has deteriorated too badly to be a feasible location for the library.

WHO MAY VOTE?

Anyone who lives in the library district and is a registered voter may vote. You may register at the polls if you bring photo identification and proof of address.

WHERE?

The Meridian Library
18 East Idaho Ave.
Meridian, Idaho

WHEN?

Tuesday, November 7, 1995
Polls open 8:00 AM to 8:00 PM

ABSENTEE BALLOTS AND INFORMATION

Call 888-4451

THIS COULD BE YOURS!

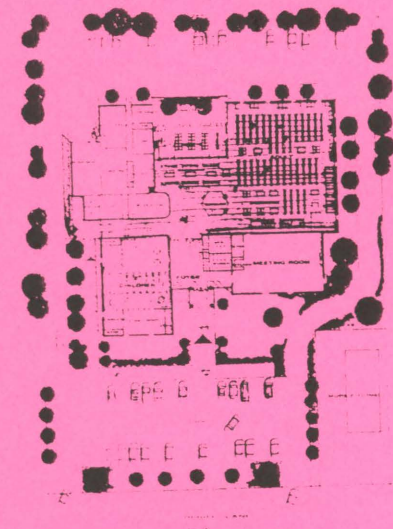

**VOTE YES
LIBRARY BOND
NOVEMBER 7, 1995**

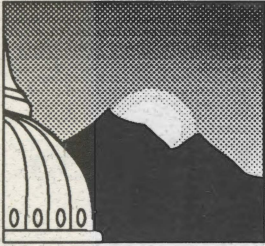

Idaho State Library *NEWSLETTER*

Volume 34; No. 12
December, 1995

Meridian Public Library passes \$3.4 million bond

Construction could start in May for a new Meridian Public Library building. Voters overwhelmingly approved a \$3.4 million bond election on November 7.

"I think it says that a lot of the new people moving in are more interested in their community, and the older residents are as well," library director Patty Younger said. "It's a wonderful thing for Meridian."

The new library will be 30,000 square feet. Its children's section alone will be 4,500 square feet — the total size of the current library. The new library will also include parking for 68 vehicles, a community meeting room, quiet adult reading room, public use computers, quiet study areas, expanded reference and magazine sections, and compact discs will be available for checkout. Younger said it would take about a year to build the facility.

The bond passed with 77 percent approval. A super-majority of 66.7 percents was needed for passage. Younger said turnout was a record for a Meridian library bond, at 2,330. A \$2.6 million bond for the library failed last February. The 20-year bond will increase property taxes by 25 cents per \$1,000 of taxable value.

Election officials report 14.8 percent of registered voters came out to vote in this election. Younger cred-

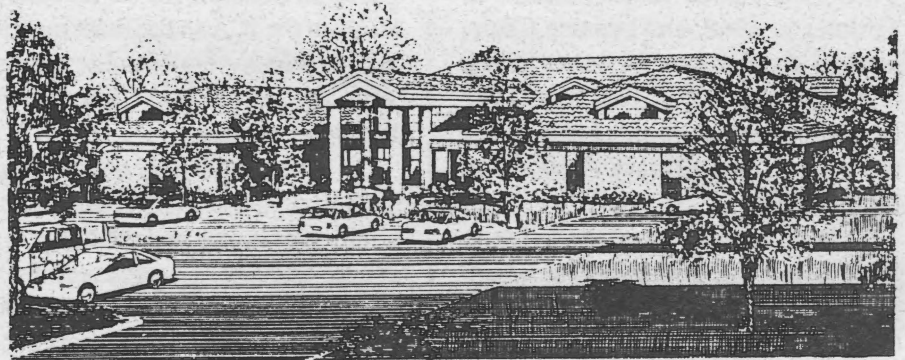

An artist's rendering of the new Meridian library.

its this bond's success to increased public awareness. She also said it helped to have a rendering of the proposed building and a location planned a head of time. The Friends of the Library and Board and staff members spent a great deal of time working on publicity, creating flyers and banners, planning media events and conducting a door to door campaign the Saturday before the election which covered the town.

"We did everything we could possibly think of to get coverage about our needs," Younger said.

Although the staff is excited about the bond's passage, they realize they have "more work ahead than we could imagine." Younger met with

planning and zoning people the day after the election and need to have all their bid specifications done by April in order to meet their May deadline for beginning construction.

Younger said local librarians have been very supportive of their efforts. Younger and directors of the Boise Public Library, Ada Community Library and Caldwell Public Library will be meeting next week with the library's architect to go over the building plans and make suggestions based on their experiences with library building projects.

"We want the plan to be as fool-proof as possible," Younger said. "We're talking about a lot of money. It's great that they are doing this."

Crews recently completed construction of the new Meridian Public Library and Director Patty Younger is taking this month to move in new furniture and equipment, and install computers and bookshelves. The library will be closed for one week and hold its grand opening celebration on May 16. (Idaho Statesman)



New Meridian library draws excitement. Above, Meridian District Library Director Patricia Younger and Gov. Phil Batt cut the ribbon on the new 30,000 square foot library on May 16. The building replaces a 4,500 square foot structure that housed the library for 55 years. Construction on the building began about a year ago with minor delays. Younger said construction costs should be about \$250,000 under budget with the remaining monies going to additional books and materials. Amenities at the new library include a computer lab, large children's section, expanded young adult section, a quiet adult reading area, large community meeting room, study rooms, about 50 soft cushioned seats, 15 catalog computers, 98 parking spaces, and a new outdoor fountain provided with private donations. The facility was built with the help of a \$3.4 million bond issue voters overwhelmingly approved in 1995.

Meridian District Library is the latest library to join a consortium that makes it easier for cardholders to check out and return materials. Beginning October 1, 1997, Meridian library patrons will be able to check out books from Boise, Nampa, Caldwell and Twin Falls libraries. Using a shared circulation system called Dynix, residents can browse titles from other libraries and order them through interlibrary loan or pick up the materials themselves. With a valid library card, residents will have access to about 675,000 volumes, including the 40,000 volumes currently available at the Meridian library. When the new library opens on May 19, it will have 16 computers available to the public for checking items at other libraries. (Idaho Statesman)

The new Meridian Public Library has increased its business by four times — an average daily attendance of 1,200 — and is working to keep pace with the patrons, process new inventory and get books out on the shelves. The summer reading program was such an overwhelming success that it had to close enrollment on the third day of a week-long registration. (Idaho Statesman)

Oldtown library branch to open with 2,000 books

The Meridian Public Library's Oldtown Branch will open Tuesday morning with fewer books than hoped. ("Library's Oldtown branch to reopen, serving local patrons," Sept. 16.)

Instead of having the 5,000 volumes the library staff had wanted for the opening, only about 2,000 will be on its shelves.

Library Director Patty Younger expects donations to fill the void.

"We've got more on the way," she said Friday. "And even though all of the furniture isn't here yet, the books we have are on the shelves."

The old library closed six months ago when Meridian's new library opened at 1326 Cherry Lane. After no one bid on the vacant downtown building, Library Board members decided to open it from 10 a.m. to 4 p.m.

each weekday.

The branch library's collection will include popular materials, large print books and a few reference materials. Its patrons will be able to access the large selection of books at the new one, too.

TAKE
2

Empty shelves to be filled with books

Sorority launches drive to benefit two libraries

By Victoria Scanlan
The Idaho Statesman

MERIDIAN — A citywide book drive should help librarians at two Meridian sites fill their shelves this month.

Members of Meridian's Delta Iota chapter of Beta Sigma Phi have placed book collection boxes at eight locations throughout the city this week.

The service sorority will collect the books on Oct. 24.

Beneficiaries will be the Meridian Public Library's downtown branch and Chaparral Elementary School's library.

Librarians at both places said they can use the help.

"We hope our effort will benefit young readers and promote literacy in our classrooms," volunteer Tammy de Weerd said. "Whatever is left over will go to needy kids who wouldn't otherwise have books of their own."

Local residents may leave new or slightly used books in any of the eight boxes around town.

The downtown library will receive

books beginning Oct. 14. But assistant director Donna Ugarriza said the library only bought about 1,000 adult books and 100 children's books for the branch, located near City Hall.

The branch will have room for up to 5,000 volumes, however, including popular materials, large print books and a small selection of reference materials. About a third of the shelves will be dedicated to kids; librarians hope to collect more than 3,000 additional children's books.

"We'll fill the rest of the shelves with donations," Ugarriza said. "So we're thrilled to get whatever gifts we can."

Volunteers will give half of the books to Chaparral's librarian on Oct. 24. They'll present the remainder to the Meridian Public Library staff on Oct. 25 — Make A Difference Day.



Tom Shanahan/The Idaho Statesman
Tammy de Weerd, left, and Stephanie Killebrew set up a book drop box at the new Meridian Library.

Sponsored by USA Weekend Magazine, Make A Difference Day rallies Americans of all ages to volunteer in their communities. Children will also help in Meridian's latest campaign.

Anne Leonard, who heads up the Kid Staff service group at

Drop box locations

Here are locations of book drop boxes in this month's citywide book drive in Meridian:

- Albertson's, 20 E. Fairview Ave.
- Albertson's, 3301 W. Cherry Lane
- Chaparral Elementary School, 1155 N. Deer Creek Lane
- Meridian City Hall, 33 E. Idaho Ave.
- Meridian Public Library, 1326 Cherry Lane
- The Idaho Athletic Club, 1450 E. Fairview Ave.
- The Valley News office, 815 E. 1st St.
- US Bank, 220 Cherry Lane

Chaparral Elementary, said the club's 42 members made colorful posters that will advertise the effort throughout the city.

"They're excited about this," she said. "I think anytime you give kids a chance to help others, they love it."